

DATA SHEET V600F SPRING MOUNT CMS1 RANGE OPEN COIL



THIS IS NOT A STAND ALONE DOCUMENT AND UNLESS REFERRED TO IN A CERTIFIED EQUIPMENT SCHEDULE IS SUBJECT TO REVISION WITHOUT NOTICE.

CAPACITY

| TYPE | COLOUR CODE | LOAD * Kg | DEFLECTION * mm |
|------|-------------|--------------|--------------------|
| 1 | BROWN | 52 | 39 |
| 2 | GREEN | 57 | 37 |
| 3 | WHITE | 86 | 32 |
| 4 | BLUE | 119 | 28 |
| 5 | ORANGE | 150 | 24 |

*IMPORTANT : VALUES SHOWN ARE MAXIMUM WITH SPRING IN SOLID CONDITION. RECOMMENDED OVERLOAD CAPACITY IS 50%.

LOAD/DEFLECTION GRAPH

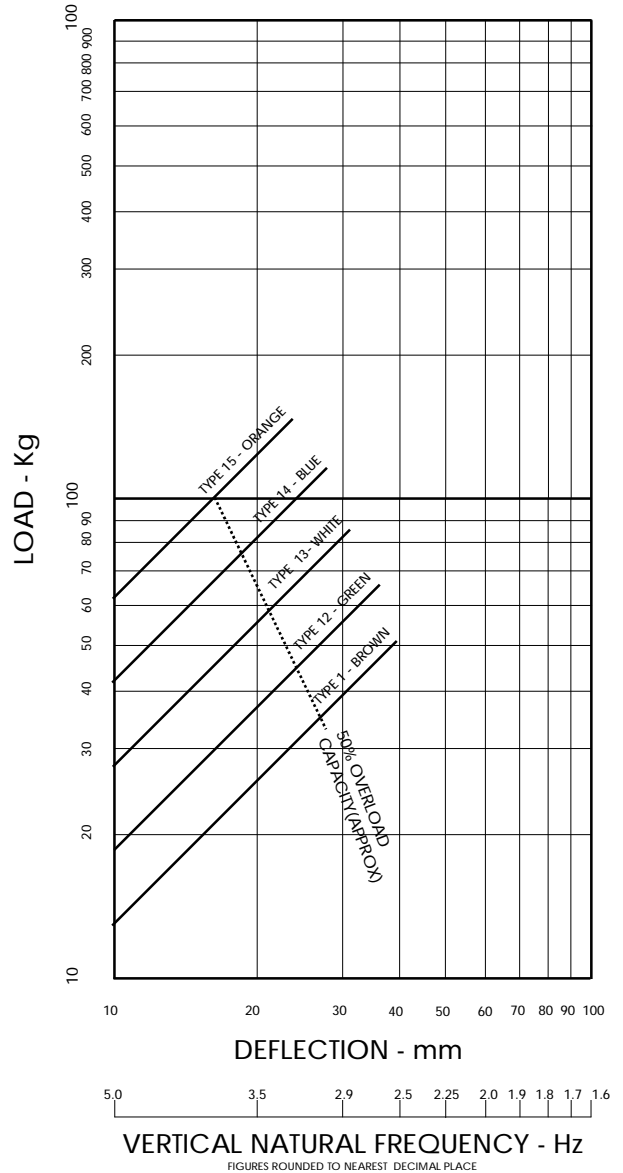

DIMENSIONS

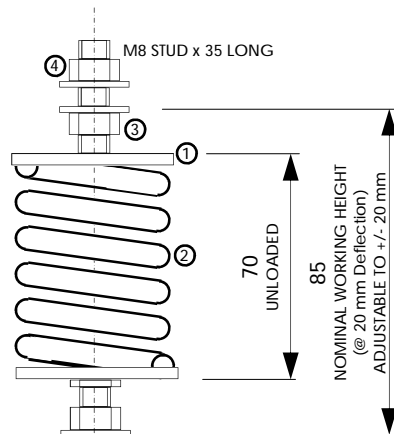

ELEVATION

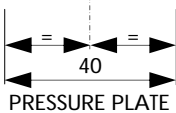
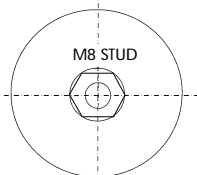

COMPONENTS

1. SPRING PRESSURE PLATE.
2. COLOUR CODED HIGH DEFLECTION STEEL SPRING .
3. ADJUSTING NUT. INSTALLERS TO LUBRICATE WITH FREEING OIL (WD40).
4. LOCKING NUT.

FINISH

PASSIVATED ZINC PLATING TO METAL COMPONENTS.

POLYESTER COATING TO SPRING (COLOUR CODED).

SUITABLE FOR USE IN NON-CORROSIVE EXTERNAL APPLICATIONS.

NOTES

THIS DATA SHEET IS TO BE READ IN CONJUNCTION WITH THE EQUIPMENT SCHEDULE.

THE SPRING WILL NEED ADJUSTING AFTER INSTALLATION.

SUITABLE FOR USE IN NON-CORROSIVE EXTERNAL APPLICATIONS.

SUFFIX

CM(-) -OPEN COIL SPRING MOUNT.

SP - SPECIAL CONSTRUCTION. SEE EQUIPMENT SCHEDULE FOR DETAILS.