

DATA SHEET A21G RECTANGULAR ATTENUATOR HORIZONTAL BEND FIRE DUCT APPLICATION MODEL SP / SL

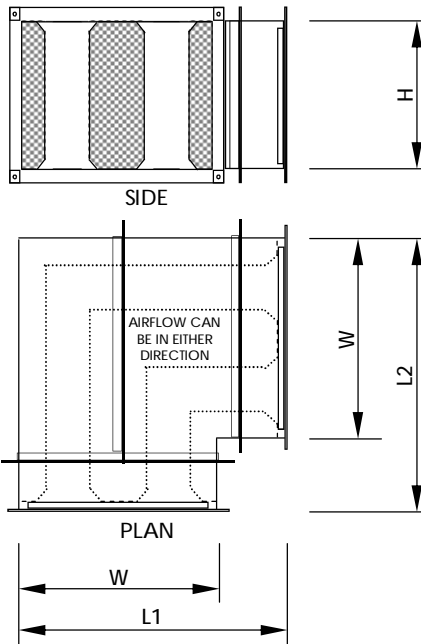

THIS IS NOT A STAND ALONE DOCUMENT AND UNLESS REFERRED TO IN A DATED EQUIPMENT SCHEDULE IS SUBJECT TO REVISION WITHOUT NOTICE.

DIMENSIONS



NOTE:

MODEL SP (ILLUSTRATED) HAS CENTRAL SPLITTER(S) AND SIDE LININGS.

MODEL SL HAS SIDE LININGS ONLY.

LENGTHS (L1) AND (L2), WIDTH (W) AND HEIGHT (H) ARE NOMINAL CASING DIMENSIONS AND EXCLUDE FLANGES.

STIFFENER(S) SHOWN FOR ILLUSTRATION ONLY. SEE TABLE BELOW FOR ACTUAL.

SUFFIX

THE SUFFIX TO THE ATTENUATOR MODEL DEFINES THE MATERIAL OF FABRICATION AND ANY ADDITIONAL FEATURES OR SPECIAL CONSTRUCTIONAL DETAILS.

BH - HORIZONTAL BEND.

H2 - FIRE DUCT APPLICATION.

G - PRE-GALVANISED STEEL CONSTRUCTION.

S - GRADE 316 STAINLESS STEEL CONSTRUCTION.

D - DOUBLE SKIN CASING (CASING SIZE W+50 x H+50).

C - HIGH PRESSURE APPLICATION (DW 144, CLASS C).

K - PROTECTIVE PAINT FINISH TO VISIBLE INTERNAL METAL SURFACES.

J - SPLITTERS AND/OR SIDE LININGS ARRANGED HORIZONTALLY.

M - MELINEX ENCAPSULATED INFILL.

Z(*) - MODULAR CONSTRUCTION (* NUMBER OF MODULES).

X - SPECIAL CONSTRUCTION, REFER TO EQUIPMENT SCHEDULE FOR DETAILS.

NOTES

THIS DATA SHEET IS TO BE READ IN CONJUNCTION WITH THE EQUIPMENT SCHEDULE.

EXCESSIVELY LARGE OR HEAVY ATTENUATORS MAY BE MANUFACTURED IN MATING SECTIONS FOR EASE OF HANDLING.

ATTENUATORS WILL BE SUPPLIED WITHOUT SUPPORT STEELWORK, BRACKETS, FIXINGS, GASKET, MASTIC OR OTHER SUCH ITEMS, UNLESS OTHERWISE STATED.

IT IS THE INSTALLERS RESPONSIBILITY TO PROVIDE THE FLANGE SEAL TO THE CONNECTING DUCT.

INSERTION LOSS, PRESSURE LOSS AND FLOW NOISE DATA ARE DERIVED FROM TESTS CARRIED OUT IN ACCORDANCE WITH ISO 7235 AND MAY VARY DEPENDING ON INSTALLED CONDITIONS.

MANUFACTURING DIMENSIONAL TOLERANCE < 1.0 %.

SPECIFICATION

ATTENUATORS ARE CONSTRUCTED IN EXCESS TO DW 144 SPECIFICATION FOR MEDIUM PRESSURE (CLASS B) DUCTWORK.

CASING

1.2 mm THICK (MIN)
LAP JOINTS (IF APPLICABLE) TO HAVE STEEL FIXINGS @ 60 CENTRES (MAX)

FLANGES

UP TO 600 LONGEST SIDE	DOBY 30 (OR EQUIVALENT)
601 - 2000 LONGEST SIDE	DOBY 40 (OR EQUIVALENT)
ABOVE 2000	50 x 50 x 5 RSA

FLANGES TO BE FIXED BY STEEL RIVET OR WELD @ 150 CENTRES (MAX)
DOBY CORNERS TO BE WELDED

STIFFENING

UP TO 400 LONGEST SIDE	NONE REQUIRED
401 - 800 LONGEST SIDE	30 x 30 x 4 RSA @ 1000 CENTRES
801 - 1500 LONGEST SIDE	40 x 40 x 4 RSA @ 800 CENTRES
ABOVE 1501	50 x 50 x 5 RSA @ 625 CENTRES

STIFFENERS TO BE FIXED BY STEEL RIVET OR WELD @ 150 CENTRES (MAX)

SPLITTERS

TO BE OF STANDARD STEEL CONSTRUCTION BUT FITTED TO CASING WITH A DOUBLE ROW OF STEEL RIVETS @ 150 CENTRES (MAX).

SPLITTERS AND SIDE LININGS CONTAIN A SOUND ABSORBENT INFILL THAT IS ENCAPSULATED WITH GLASS CLOTH AND PLAIN/PERFORATED STEEL AND HAVE AERODYNAMIC FAIRINGS AT EACH END.

GENERAL

UNTREATED STEEL, LINESH MARKS AND WELDS TO BE PAINTED INSIDE AND OUT WITH ZINC PHOSPHATE (GREY).

SEALANT TO BE INTUMESCENT / ALL STEEL RIVETS ONLY / LABELS ON INSIDE ONLY.

THIS CONSTRUCTION IS NOT FIRE CERTIFIED

WEIGHT

WEIGHTS ARE GIVEN ON THE EQUIPMENT SCHEDULE.

STANDARD SIZES

THERE ARE NO STANDARD SIZES.

ALL ATTENUATORS ARE MADE TO ORDER.

IMPORTANT

ATTENUATORS ARE INTENDED FOR POST MANUFACTURE TREATMENT BY A THIRD PARTY FIRE DUCT SPECIALIST.

THE PURCHASER HAS ABSOLUTE RESPONSIBILITY FOR PROVIDING MANUFACTURING SPECIFICATIONS OR OTHERWISE GIVING UNQUALIFIED APPROVAL OF THIS DATA SHEET.

IN ANY EVENT, ALLWAY ACOUSTICS LTD GIVE NO WARRANTY THAT ATTENUATORS MEET ANY FIRE CERTIFICATION. SUCH WARRANTIES MUST BE PROVIDED BY THE FIRE DUCT SPECIALIST.

UNTREATED ATTENUATORS DO NOT HAVE FIRE CERTIFICATION.