

# DATA SHEET V230F

## SPRING MOUNT

### CLS30 RANGE

#### CONSTANT LEVEL

THIS IS NOT A STAND ALONE DOCUMENT AND UNLESS REFERRED TO IN A CERTIFIED EQUIPMENT SCHEDULE IS SUBJECT TO REVISION WITHOUT NOTICE.

### CAPACITY

TYPE	COLOUR CODE	LOAD * Kg	DEFLECTION * mm
32	GREEN	503	79
33	WHITE	743	73
34	BLUE	1002	62
35	ORANGE	1420	54
36	PURPLE	1865	47
37	BLACK	2356	40
37N	BLACK/GOLD	3440	40

\*IMPORTANT : VALUES SHOWN ARE MAXIMUM WITH SPRING IN SOLID CONDITION. RECOMMENDED OVERLOAD CAPACITY IS 50%.

### DIMENSIONS

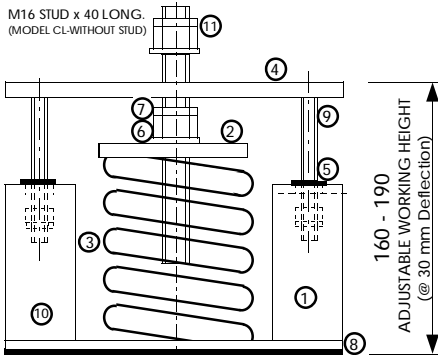

ELEVATION

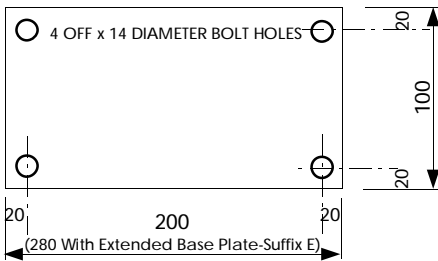

BASE PLATE

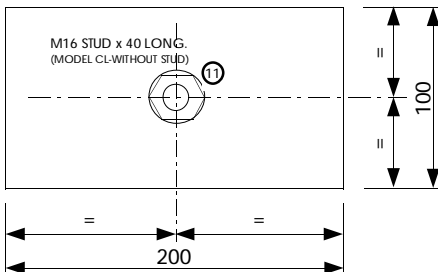

TOP PLATE

### COMPONENTS

- LOAD BEARING SUPPORTS.
- SPRING PRESSURE PLATE.
- COLOUR CODED HIGH DEFLECTION STEEL SPRING (TYPE N HAS NESTED SPRING).
- LOAD BEARING TOP PLATE.
- CLEARANCE HOLE WITH PERIPHERAL SNUBBING FOR HIGH FREQUENCY ISOLATION.
- ADJUSTING NUT. INSTALLERS TO LUBRICATE WITH FREEING OIL (WD40)
- LOCKING NUT.
- HIGH FREQUENCY ISOLATION PAD.
- TRANSPORTATION/ RESTRAINING BOLTS.
- HOLDING DOWN BOLT HOLES.
- PLANT HOLDING DOWN STUD (CAN BE OMITTED IF NOT REQUIRED-MODEL CL)

### FINISH

PASSIVATED ZINC PLATING TO METAL COMPONENTS.

POLYESTER COATING TO SPRING (COLOUR CODED).

SUITABLE FOR USE IN NON-CORROSIVE EXTERNAL APPLICATIONS.

### FEATURES

- CONSTANT LEVEL
- HIGH LOAD CAPACITY
- HIGH DEFLECTION
- ALL STEEL CONSTRUCTION
- CAPTIVE STEEL SPRING
- HIGH FREQUENCY ISOLATION
- ZINC PLATED COMPONENTS
- POWDER COATED SPRING
- COLOUR CODED



**ALLAWAY**  
**ACOUSTICS**  
LIMITED  
www.allawayacoustics.co.uk

### LOAD/DEFLECTION GRAPH

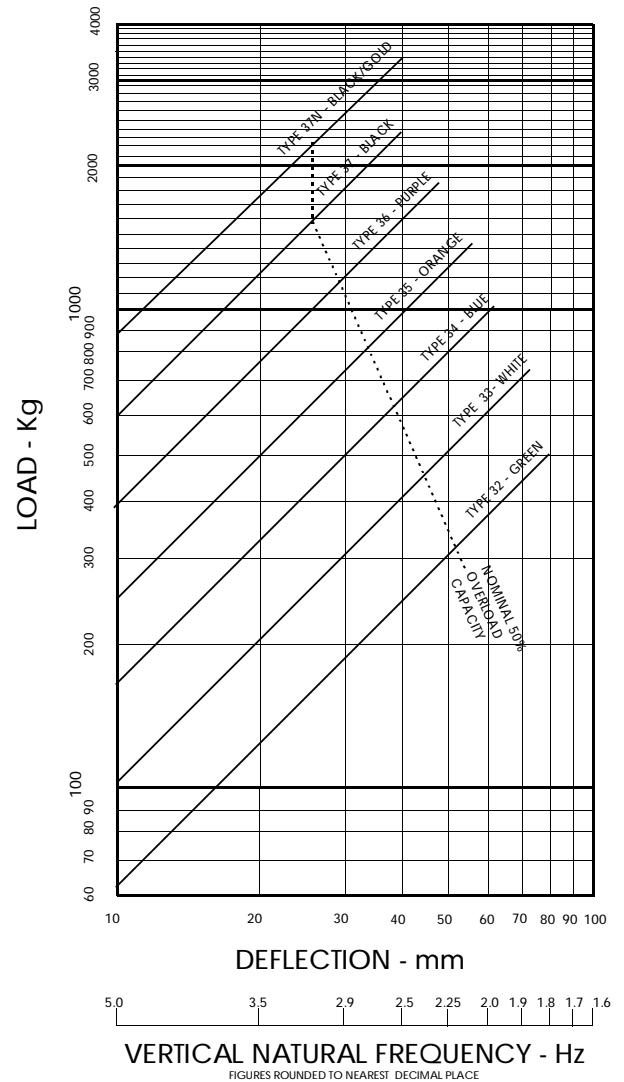

### NOTES

THIS DATA SHEET IS TO BE READ IN CONJUNCTION WITH THE EQUIPMENT SCHEDULE.

THE SPRING WILL NEED ADJUSTING AFTER INSTALLATION.

HOLDING DOWN BOLTS TO BE SUPPLIED AND FITTED BY OTHERS.

SUITABLE FOR USE IN NON-CORROSIVE EXTERNAL APPLICATIONS.

### SUFFIX

CLS(-) - CONSTANT LEVEL MOUNT WITH PLANT HOLDING DOWN STUD

CL(-) - CONSTANT LEVEL MOUNT WITHOUT PLANT HOLDING DOWN STUD

SP - SPECIAL CONSTRUCTION. SEE EQUIPMENT SCHEDULE FOR DETAILS

E - EXTENDED BASE PLATE